



Hudson Ridge

12200 Hudson Ridge Drive
Port Richey, FL 34668

TEL: 727-863-1222 • FAX: 727-863-6349
Email: hudsonridge@richmanmgt.com

The Palm

2 Bedroom / 2 Bath
974 sq. ft.

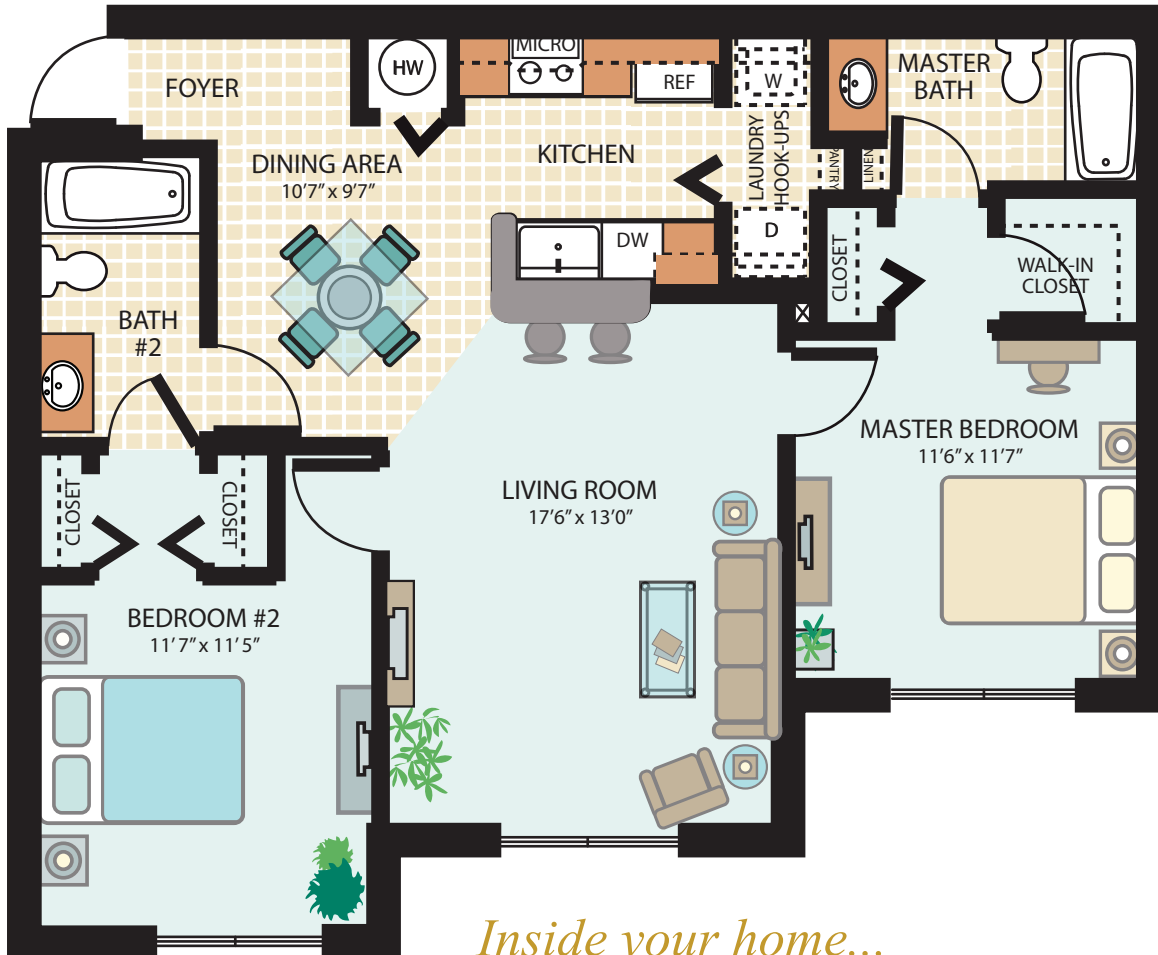

Inside your home...

- Spacious two and three bedroom floor plans
- Fully equipped kitchens including GE energy star appliances and built-in microwave
- Designer cherry cabinetry & faux granite countertops in kitchens and baths
- Energy Star impact windows
- Ceramic tile floors in select areas
- Certified Green Label berber carpeting
- Separate dining area
- Two full baths
- Walk-in closets
- Full-size washer/dryer connections
- Individually controlled central air conditioning
- Ceiling fans throughout
- Custom satellite TV packages available including HD and premier channels
- Energy Saver Plus construction



Dimensions and square footage are approximate, variations may occur in some floor plans.